

W

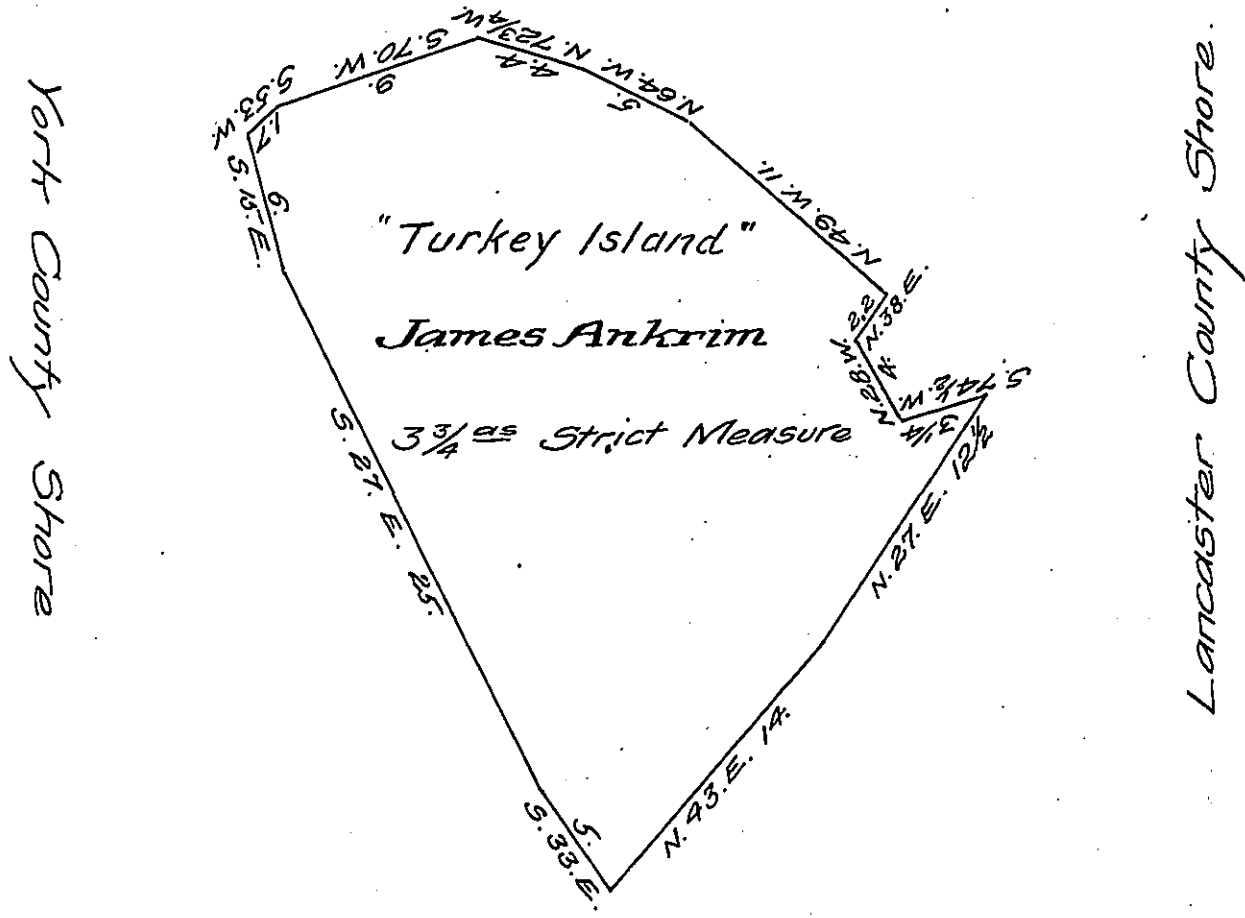

A Draught of an Island situate in the river Susquehanna in Drumore township Lancaster County being about equal distance between the Bear Island and the Lancaster shore the upper end of it opposite Neals Rock & extending down opposite to land of Thomas Neal & from ten to fifteen perches from the Lancaster shore Containing three acres & three quarters Strict Measure surveyed in pursuance of a Warrant dated the 19th day of June 1815 granted to James Ankrim.

p^c Jacob Hibshman D.S.

To Jacob Spangler Esq. }
 Surveyor General }

IN TESTIMONY that the above is a copy of the original remaining on file in the Department of Internal Affairs of Pennsylvania, made conformably to an Act of Assembly approved the 16th day of February, 1833, I have hereunto set my Hand and caused the Seal of said Department to be affixed at Harrisburg, this nineteenth day of November 1907.

Henry Howell
 Secretary of Internal Affairs.